

PRODUCT REFERENCE GUIDE

Protection & Measurement Devices - 2015



PMD Division

About Us



Vision

- To be the most trusted, respected and preferred brand
- To be closest to its customer
- To manage power in India's biggest industries, in its highest buildings, in its most critical infrastructures and in millions of its homes
- To serve as a role model to others
- To make "MADE IN INDIA" a respected label world over



Mission

- To create a unique alchemy of outstanding products, operational excellence, path breaking customer services and compelling marketing
- To create the best place to work where employees are empowered, cared, developed and provided unlimited opportunities
- To continuously innovate, enhance our core technologies and develop new world class products
- To be India's largest exporter of industrial power distribution and control equipment
- To everyday experience, the sheer joy of delighting our internal and external customers
- To earn healthy return on investment



Quality at Source

- ❖ The ISO 9001:2008 certificate from DNV reiterates that the standard of design, manufacturing and service provided by us follow most stringent control and supervision procedures
- ❖ Our R&D facilities stand recognized by Govt. of India for the high quality of developments & new products. We are member of FITT (Foundation for Innovation and Technology) body run by IIT, New Delhi, INDIA.



GOVERNMENT OF INDIA
 MINISTRY OF SCIENCE & TECHNOLOGY
 Department of Scientific & Industrial Research,
 Technology Bhavan, New Mehrauli Road, New Delhi - 110 016
 R&D RECOGNITION BY GOVT. OF INDIA



Table of Contents



- ❖ CSEZEN Multi-protection Series 04
- ❖ CSPRO Series 05
- ❖ CSENEXT Series 06
- ❖ IRI-PRO Series 07
- ❖ Generator Solution 08
- ❖ Auxiliary Relays 09
- ❖ Electronic Motor Protection Relay (EMPR) 10
- ❖ Self Powered Relay for RMU 11
- ❖ Fault Passage Indicator for RMU 12
- ❖ Live Line Indicator 13
- ❖ Digital Panel Meters 14
- ❖ APFC (Power Factor Controller) 15

CSEZEN Multi protection Series



CSEZEN Protection Solutions for HV/MV Feeder, Generator, Motor and Transformer

- ❖ 7 CT + 4 PT : Analog Inputs
- ❖ 1A/5A Rated CT (Site Selectable)
- ❖ 50/60 Hz Nominal Frequency (Site Selectable)
- ❖ Wide Range Auxiliary Supply
- ❖ Self CT Shorting Modular Design
- ❖ 16 DI / 16 DO programmable
- ❖ IEC 61850/IEC-103/MODBUS Communication Protocol
- ❖ USB / OTG Communication

Fault Record	Event Record	Oscilloscope Record
20	500	1200

PROTECTIONS	F-500	M-500	T-500
Transformer Differential (87P)	x	x	✓
3 Ph Over current (50/51P)	✓	✓	✓
Earth Over current (50N/51N)	✓	✓	✓
Locked Rotor (50LR)	☒	✓	☒
Stall (50S)	☒	✓	☒
Startup monitoring / Excessive long start (66/48)	☒	✓	☒
Restricted Earth Fault (64N/87G)	✓	☒	☒
3 Ph Directional Over current (67P)	✓	☒	☒
Earth Fault Directional Over current (67N)	✓	☒	☒
Voltage Controlled Over current (51V)	✓	☒	☒
3 Ph Under current (37P)	✓	✓	☒
Negative Phase Sequence Over current (46)	✓	✓	✓
Phase under/over voltage (AND & OR mode) (27/59)	✓	✓	✓
Negative Over voltage (47)	✓	✓	☒
Power Protection (Under/Over/Reverse power) (32)	✓	✓	☒
Under/over Frequency (81 U/O)	✓	✓	☒
Rate of Change of Frequency (81R)	✓	☒	☒
Thermal Over load (49)	✓	✓	✓
Output Relay Latching (86)	✓	✓	✓
Auto Reclose (79)	✓	☒	☒
Circuit Breaker Failure Detection (50BF)	✓	✓	✓
Broken Conductor (46BC)	✓	☒	☒
Over Excitation (24)	☒	☒	✓
Blocking Logic	✓	✓	✓
Test of Output Relays (Maintenance)	✓	✓	✓
CB Control Local/Remote	✓	✓	✓
Circuit Breaker Maintenance & Trip circuit Supervision	✓	✓	✓
Cold Load Pickup	✓	☒	☒
Selective Relay Scheme Logic	✓	✓	✓
Over Fluxing/5th Harmonic/2nd Harmonic	☒	☒	✓
Inrush Blocking	✓	☒	☒
Switch on to Fault (SOTF)	✓	☒	☒
CT Supervision (CTS)	✓	✓	✓
VT Supervision (VTS)	✓	☒	✓

CSEPRO Series

CSEPRO Protection Solutions for Distribution

- ❖ Multi-function Protection for Distribution
- ❖ 7 CT + 3 PT : Analog Inputs
- ❖ 1A/5A Rated CT (Site Selectable)
- ❖ 50/60 Hz Nominal Frequency (Site Selectable)
- ❖ Wide Range Auxiliary Supply
- ❖ Self CT Shorting Modular Design
- ❖ 6 DI / 6 DO programmable
- ❖ IEC 61850/IEC-103/MODBUS Communication Protocol
- ❖ USB Communication

Fault Record	Event Record	Oscilloscope Record
10	100	1200



PROTECTIONS	F220	F300	T140	T170	M200
3 Phase Over current (50/51P)	✓	✓	✓	✓	✓
Earth Over current	✓	✓	x	✓	✓
Under Voltage (27)	x	✓	x	x	x
Over Voltage (59)	x	✓	x	x	x
Neutral Displacement (59N)	x	✓	x	x	x
Transformer Differential (87T)	x	x	✓	✓	x
Restricted Earth Fault (64/87G)	✓	✓	x	✓	x
Locked Rotor (50LR)	x	x	x	x	✓
Stall Protection (50S)	x	x	x	x	✓
Under Current (37)	✓	✓	x	x	✓
Thermal Over load (49)	✓	✓	x	x	x
Voltage controlled Over current (51V)	x	x	✓	x	x
Current Unbalance / NPS (46)	✓	✓	✓	✓	✓
Negative Sequence Over Voltage (47)	x	x	✓	x	x
Latching Relay (86)	✓	✓	✓	✓	✓
CBFP Protection (50BF)	✓	✓	✓	✓	✓
Inrush Blocking	✓	✓	✓	✓	✓
Trip Circuit Supervision (TCS)	✓	✓	✓	✓	✓
Auto Recloser (AR)	✓	✓	x	x	x
Broken Conductor (46BC)	✓	✓	x	x	x
Cold Load Pickup	✓	✓	x	x	x

Common Data

Aux Voltage		L/H = Either 18-60V DC / 80-300V AC-DC
CT Secondary	1A/5A	Programmable
Relay Size (HxWxD) in mm		156x125x249
Cut out Size (HxW) in mm		145x112
Relay Case		Draw-Out

Features

Fault Recorder	10	10	10	10	10
Event Recorder	100	100	100	100	100
Disturbance Recorder	✓	✓	✓	✓	✓
Digital Input	6	6	4	6	6
Digital Output	6	6	4	6	6
Front USB	✓	✓	✓	✓	✓
RS-485 (Modbus)	✓	✓	✓	✓	✓
RS-485 IEC 60870-5-103	○	○	○	○	○
RJ-45 IEC61850	○	○	○	○	○
SNTP Time Synch RJ-45	○	○	○	○	○

CSE Nex Series



CSE Nex Protection Solutions for Distribution

- ❖ Over-current Protection
- ❖ Voltage Protection
- ❖ Motor Protection
- ❖ 1A/5A Rated CT (Site Selectable)
- ❖ 50/60 Hz Nominal Frequency (Site Selectable)
- ❖ Wide Range Auxiliary Supply
- ❖ Self CT Shorting Modular Design
- ❖ MODBUS / IEC-103
- ❖ USB Communication
- ❖ 4 DI / 4 DO programmable

PROTECTIONS	Nex 100/101	Nex-I 201/202/203	Nex-I 300	Nex-U 200	Nex-M 100
IDMTL Over current & Earth Fault (51/51N)	✓	✓	✓	x	✓
Instantaneous Over current & Earth Fault (50/50N)	✓	✓	✓	x	✓
Cold Load Pickup	✓	✓	✓	x	✓
Inrush Blocking (51H)	✓	✓	✓	x	✓
Under Voltage (27)	x	x	x	✓	x
Over Voltage (59)	x	x	x	✓	x
Neutral Displacement (59N)	x	x	x	✓	✓
Locked Rotor (50LR)	x	x	x	x	x
Stall Protection (50S)	x	x	x	x	x
Under Current (37)	x	x	x	x	x
Thermal Over load (49)	x	x	x	x	x
Current Unbalance / NPS (46)	x	x	✓	x	x
Negative Sequence Over Voltage (47)	x	x	x	✓	x
Latching Relay (86)	✓	✓	✓	✓	✓
CBFP Protection (50BF)	✓	✓	✓	x	✓
Trip Circuit Supervision (TCS)	x	✓	✓	✓	✓
Auto Recloser (AR)	x	x	✓	x	x
Broken Conductor (46BC)	x	x	x	x	x

Common Data

Aux Voltage	L/H = Either 18-60V DC / 80-300V AC-DC			
CT Secondary		Optional	Available	Available
Relay Size (HxWxD) in mm	1A/5A	152x112x153		
Cut out Size (HxW)		145x112		
Relay Case	Optional		Draw-Out	

Features

Fault Recorder	10	10	10	10	25
Event Recorder	16	16	500	100	50
Disturbance Recorder	x	x	3	x	x
No. of Group Settings	1	1	4	2	1
Digital Input	x	2	x	✓	x
Digital Output	4	4	x	✓	x
Front USB	✓	✓	✓	✓	✓
RS-485 (Modbus)	Optional	Optional	✓	✓	✓
RS-485 IEC 60870-5-103	x	x	x	Optional	x

IRI-PRO Series

IRIPRO Range offers following Protection Solutions

Hardware

- ❖ Micro-controller based Numeric Design
- ❖ Measures True RMS with DFT Filter
- ❖ 4 Current Analog Inputs
- ❖ Bright LCD Display
- ❖ USB communication / RS-485 Rear Communication
- ❖ 15 LEDs for Annunciation



Protection Features

- ❖ 3 Phase Time Over-current Protection (51)
- ❖ 3 Phase Instantaneous Protection
- ❖ Earth Time Over-current (51N)
- ❖ Earth Instantaneous Over-current (50N)
- ❖ Circuit Breaker Failure Protection (50BF)
- ❖ Under / Voltage Protection (27/59)
- ❖ Neutral Displacement (59N)



PROTECTIONS	IRIPro V4	IRIPro V2/V3	IRIPro V3-EO	IRUPro UOR	IRI-ES	IRI-1ER	IRD1-T2
Current Differential (87)	x	x	x	x	x	x	✓
IDMTL Over current (51)	✓	✓	x	x	x	x	x
Instantaneous Over current (50)	✓	✓	x	x	x	x	x
IDMTL Earth Fault (51N)	✓	✓	✓	x	x	x	x
Instantaneous Earth Fault (50N)	✓	✓	✓	x	x	x	x
Inrush Blocking (51H)	x	x	x	x	x	x	✓
Sensitive Earth Fault (50SN)	x	x	x	x	✓	x	x
Under Voltage (27)	x	x	x	✓	x	x	x
Over Voltage (59)	x	x	x	✓	x	x	x
Neutral Displacement (59N)	x	x	x	✓	x	x	x
Negative Sequence Over Voltage (47)	x	x	x	✓	x	x	x
Restricted Earth Fault (64)	x	x	x	x	x	✓	x
CBFP Protection (50BF)	✓	x	✓	x	x	x	x
CT Input	1A & 5A	1A or 5A	1A or 5A	x	1A or 5A	1A or 5A	x

Common Data

Aux Voltage	L/H = Either 18-60V DC / 80-300V AC-DC		
Relay Size (HxWxD) in mm	142x76x148	76x1462x148	142x76x148
Cut out Size	136x68	68x136	136x68
Relay Case	Non Draw-Out		Draw-Out

Features

Fault Recorder	5	5	5	10	x	x	x
Event Recorder	x	x	x	100	x	x	x
Digital Output	3	3	3	3	2	2	x
Front USB	✓	✓	✓	✓	x	x	x
RS-485 (Modbus)	✓	x	x	✓	x	x	x

Generator Solution

Special Products for Grid Islanding



Features

- ❖ MRI1-IR-SR - Directional Over Current + Earth Fault Relay
- ❖ MRQ1 - Field Failure Relay
- ❖ MRP2 - Reverse Power Relay
- ❖ MRF2 - Under & Over Frequency with df/dt Relay
- ❖ MRN2 - Mains Decoupling Relay
Combination of Under & Over Voltage, Under & Over Frequency with df/dt protection (or) Vector Surge Protection Relay
- ❖ MRG2 - VECTOR SURGE Relay
- ❖ MRR1 - Rotor Earth Fault Relay

Generator Protection Solutions (Basic Range)



- ❖ BU1-AC-UO - Under & Over Voltage Relay
- ❖ BF1-UO - Under & Over Frequency Relay
- ❖ BP1-R - Reverse Power Relay
- ❖ BA-1 - Voltage Balance Relay

Auxiliary Relays

MRA-Pro-V2 supervision relay is a advance numeric relay that provides circuit breaker supervision

Features

- ❖ Continuous Trip Circuit Supervision of both pre closing and post closing conditions in circuit breaker
- ❖ Detection and Alarm of trip circuit supply failure and circuit breaker tripping mechanism failure such as loss of voltage, trip circuit connection, contact degeneration in wires, contacts and coils
- ❖ Single Phase CB monitoring
- ❖ Flush mounting enclosure
- ❖ 2 Output contacts
- ❖ Operation delay to avoid spurious signals for instance on circuit breaker operations
- ❖ Functional Operation indication by 4 LEDs namely CB OK, CB Fail Manual & Edit
- ❖ Test function for Self test facilitates routine maintenance
- ❖ Auto / Manual operation mode



MRA-Pro-V2

The Lockout Relay CLR series are equipped with following:

Features

- ❖ Electro-mechanical Design
- ❖ Suitable for Tripping, Signaling in Protection & Control System
- ❖ Consistent and repeat Accuracy
- ❖ High resistance to Shock & Vibration
- ❖ Flexible user friendly standardized contacts arrangement
- ❖ Hand Reset flag indication
- ❖ Compact Panel mounting case
- ❖ High Speed with positive operation



CLR

The CAR type auxiliary relay are voltage operated relays, mainly used in control and alarm circuits.

CAR series of relay are available in two basic models CAR-H and CAR-S Auxiliary relay CAR-H is provided with hand reset contacts. CAR-S is self reset type.

CAR series of relay are available in two elements & 3 elements model. Each element can be energized separately

The CAR series of relays are used in various applications such as:

- ❖ Switching functions in protection and control circuits
- ❖ Contact multiplication
- ❖ Other Auxiliary and Alarm functions



CAR

Electronics Motor Protection Relay (EMPR)

mPRO

Modular Motor Protection & Control Relay for LV Motors. It includes three phase current monitoring with integral CT in a range of 1A to 60A current. It provides Modbus communication (RS-485), RTD input & 4-20mA Output, Digital Input & Output

Protection

Functions	ANSI	CSMPA	CSMPM	mPRO-100	mPRO-200
Over current	51	●	●	●	●
Stall Protection	51S	●	●	●	●
Unbalance / Asym	46	●	●	●	●
Phase Reversal	47	●	●	●	●
Phase Loss	PL	●	●	●	●
Locked Rotor	51LR	○	●	●	●
Earth Fault	51N	○	●	●	●
Under Current	37	○	●	●	●
Thermal Over-load	49	○	○	●	●

Common Data

Aux Voltage		110V / 220V AC		Universal	Universal
Current Range	A	1.5/5/22/40/80	(5-60)/(0.5-6.0)	(1-60)/0.25-5	(1-60)/0.25-5
Display		LED			LCD
Enclosure Type		DIN Rail			

Features

Fault Recorder		-	-	1	1
Digital Input		-	-	-	2
Output		1NO+1NC	1NO+1NC 2NO+2NC	1C/O+2NO	1CO+2NO
Miscellaneous (Product Highlight)		Application 0.2+HP onwards	Load Bar graph & Current Measurement	Load Bar graph with Run & Trip LEDs	External CT Fail safe Operation/ DI-DO programmable Thermal record Motor Start- Stop History
RS-485 (Modbus) / (4-20mA)/RTD	-	-	-	-	Optional



mPRO on DIN Rail mounting



mPRO with external CT



mPRO with ZCT



Self Powered Relay for RMU

CSDPR-V2

- ❖ Numeric multi powered Over-current relay with Display
- ❖ Low VA Burden
- ❖ Small & compact size
- ❖ Get energizes from any one : CT, VT, Battery, USB
- ❖ O/C, S/C, E/F and E/F High set / Unbalance / TCS / CBFP protection
- ❖ RS-485 Modbus communication Rear panel / USB port for PC / Laptop
- ❖ Event / Fault record with Time stamp
- ❖ Remote trip / Remote protection block
- ❖ 4 Output relays out of which 2 programmable
- ❖ Two set of setting group
- ❖ Potential pulse output for direct triggering the circuit breaker coil.
(Potential free contacts also available)



CSPR-V5

- ❖ Compact Numeric Self Powered Over-current Relay
- ❖ Potential pulse output for direct triggering the Circuit Breaker Coil
- ❖ O/C, S/C, E/F, E/F High set protection
- ❖ Low VA Burden
- ❖ Fault / Event Record
- ❖ RS-485 Modbus Communication



Technical Data

Rated Aux Voltage (UH)	: 85-265V AC/110-300V DC/18-60V DC
Rated Phase Current (In)	: 1A / 5A
Current Measuring Range	: 30xIp
Thermal Load Capacity	: Continuous = 2xIn : for 1 sec = 20xIn
Rated Frequency (Fn)	: 50/60 Hz
Digital Input	: 02 No.
Digital Output Contacts	: 04 Nos
Potential Pulse Output	: 24V@0.2Ws
Front Port	: USB
Rear Port	: RS-485 on MODBUS / IEC-103

Records

Fault Recorder	: 05 (non volatile with Date/Time stamp)
Event Recorder	: 10 (non volatile with Date/Time stamp)

Tests & Environment

Design	: IEC 60255
Operating Temperature	: -25 to +70°C
Weight	: 2.0 kg

Fault Passage Indicator for RMU

CSFPI



Short Circuit Sensor

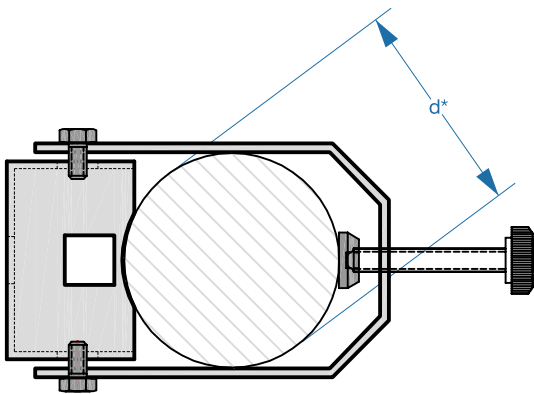

Earth Fault Sensor

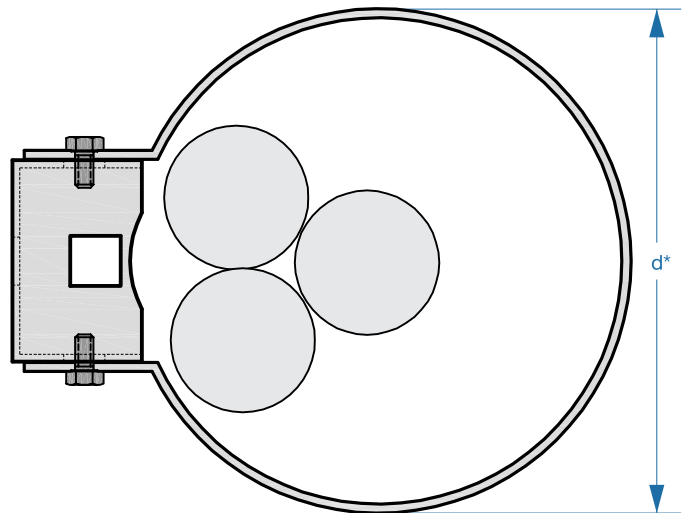

Sensor dia (d)	Cable dia
D1	15-25 mm (Round)
D2	18-44 mm (Round)
D3	40-60 mm (Round)

Sensor dia (d)	Cable dia
D1	80-100 mm (Round)
D2	100-120 mm (Round)
D3	120-140 mm (Round)

Introduction

CSFPI is designed to detect and indicate Earth fault and Short circuit on a cable system, which can be used in RMU networks with one input / open ring arrangement. The unit will indicate a fault condition when current is detected above present amperage trip current settings. Fault current is sensed by cable mounted sensor, which gives signal to Front display unit. All sensors are clamp type sensor and can be retrofitted on the cable.

Features

- ❖ Programmable Short Circuit Pickup level (Wide Range 100A to 1200A)
- ❖ Programmable Earth Fault Pickup level (Wide Range 10A to 100A)
- ❖ Indication of permanent Earth Faults by blinking of Earth Fault LED
- ❖ Indication of a Short Circuit by blinking of the Short Circuit LEDs
- ❖ Programmable response delay for Short Circuits and Earth Faults (individually)
- ❖ Up-to Three potential free contacts to indicate Earth Fault, Short Circuit and Battery Low remote indication
- ❖ Various Reset option for a Fault Reset (current recovery / potential free input / press by push button / by SCADA / by time)

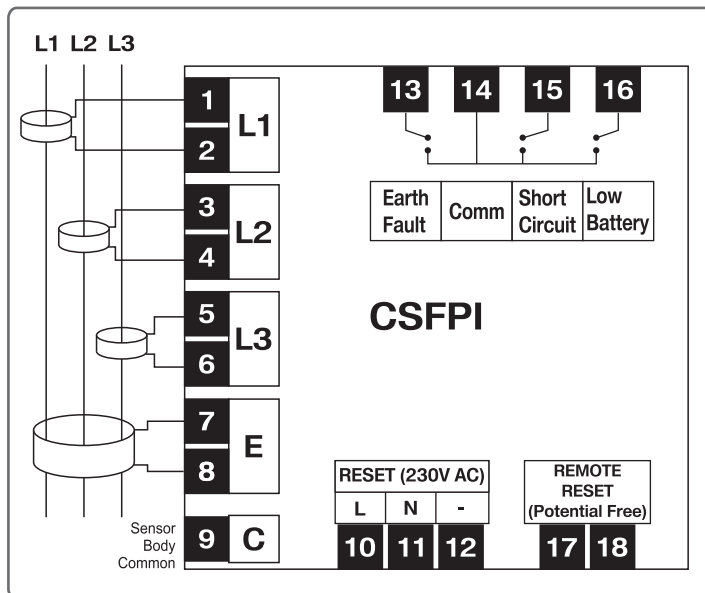

Live Line Indicator

- ❖ Capacitive based Indicator for High Voltage
- ❖ Three phase live line indicator as per IEC-61243-5
- ❖ Compatible for different capacitor based insulator (3kV to 24kV)



LLI

Digital Panel Meters



ARTIS Series



VERTIS Series

Single Phase / Single Function, Three Phase / Single Function & Multi Function Meter

Features

- ❖ True RMS measurement
- ❖ Accuracy as per IEC 61036
- ❖ Password protected parameter
- ❖ Programmable CT/PT Ratio
- ❖ Auto scrolling of parameters
- ❖ Compact size of 96 x 96 mm
- ❖ Micro processor based Digital Panel Meter Series

CSM-E Model No.	Description
CSM-P1-S1-C	1 Phase PF Meter with Comm.
CSM-V3-S1-C	3 Phase Volt Meter with comm.
CSM-I3-S1-C	3 Phase Ammeter with comm.
CSM-E3-S3-D	3 Phase Dual Source kWh Meter
CSM-E3-S3-C	3 Phase kWh Meter with comm.
CSM-E3-S3-D-C	3 Phase Dual Source kWh Meter with Comm.
CSM-M3-S3-C	3 Phase V+I+F Meter with comm.
CSM-M4-S3-C	3 Phase V+I+F+PF+KW Meter with comm
CSM-M5-S3-D	3 Phase Dual Source V+I+F+kW+kVA+kWh Meter
CSM-M5-S3-C	3 Phase V+I+F+kW+kVA+kWh Meter with Comm.
CSM-M5-S3-D-C	3 Phase Dual Source V+I+F+kW+kVA+kWh Meter with Comm.

APFC



CSPF-100

- ❖ 8/12/14/16 Power Factor Controller
- ❖ Metering
- ❖ Harmonic
- ❖ Auto Setting
- ❖ Capacitor Bank Protection
- ❖ Protection on insufficient compensation/Over voltage/Current
- ❖ Effective PF Control. Up to 12 capacitor banks controllable
- ❖ Full Functional 16 x 4 LCD display for user friendly interface
- ❖ Auto / Manual Operation
- ❖ Wide range of measuring voltage Input
- ❖ True RMS measurement of AC parameters
- ❖ Measurement & display of line parameters like V, I, P, Q, S, Cos ϕ
- ❖ Indication of Capacitor Bank switched through Front LEDs
- ❖ Wide range of Programmable parameter including CT/PT ratio, target Cos ϕ value, Capacitor Bank switching program etc.
- ❖ Protection & Indication on abnormal condition such as Over/Insufficient Compensation, Voltage Harmonics, Over Voltage, Over/Under Current etc.
- ❖ No-Voltage Turn off
- ❖ Field accessible test mode for relay contact check
- ❖ 144x144 mm Panel mountable housing
- ❖ Alarm output on abnormal conditions

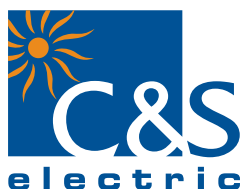

Marketing Offices

<p>Ahmedabad 9th Floor, "HERITAGE", Nr. Gujarat Vidhyapith, B/h Visnagar Bank, Ashram Road, Ahmedabad-380014 (INDIA) Tel: +91 79 3007 4534/35, 3007 4536 Fax: +91 79 3007 4519</p>	<p>Cochin Door No. 33-2361 B-3-C, 2nd Floor, Jacob's Building, Geethanjaly Junction, NH Bypass, Vyttila, Cochin-682 019 (INDIA) Tel:+91 0484 3071717, 3071709 Fax:+91 0484 3071716</p>	<p>Indore 303, J.V. Complex, Opp. Abhay Prashal, 13/2, Race Course Road, Indore - M.P. (INDIA) Tel: 0731 - 3918020, 4035761 Fax: 0731 - 3918017</p>
<p>Bangalore N-607, North Block, Rear Wing, Manipal Center, 47, Dickenson Road, Bangalore - 560 042 (INDIA) Tel: +91 80 3057 0372/73, 3057 0347 Fax: +91 80 2558 4839</p>	<p>Coimbatore K.C. Arcade, 3rd Floor, 79/2, Sir Shanmugam Road, R.S. Puram, Coimbatore-641 002 (INDIA) Tel: +91 0422 3048416 Fax: +91 0422 3048412</p>	<p>Kolkata Development House, 4th Floor, 24 Park Street, Kolkata - 700 016 (INDIA) Tel: +91 33 2227 5850/51, 64542983 Fax: +91 33 2227 5849</p>
<p>Baroda 604, Citadel, Windsor Plaza R. C. Dutt Road, Baroda-390005 (INDIA) Mobile: +91 9408726897</p>	<p>Delhi 222, Okhla Industrial Estate, Phase-III, New Delhi - 110 020 (INDIA) Tel: +91 11 3088 7520-29 Fax: +91 11 2684 7154</p>	<p>Mumbai A-301/302, 3rd Floor, Nav Bharat Estate, Zakaira Bunder Road, Sewri (W) Mumbai - 400 015 (INDIA) Tel: +91 22 3048 7146/47 Fax: +91 22 2412 6631</p>
<p>Bhubaneswar Prema House, Plot No. - 222 C, 1st Floor, Sector - A, Zone - B, Mancheswar Industrial Estate, Bhubaneswar - 751010 (INDIA) Tel: +91 674 3270465 Telefax: +91 674 2580788</p>	<p>36 Garh Maruti Height, 2nd Floor, Amanaka, G.E. Road, Raipur (36garh). Pin No. 492001 India Tel. No. 3208524, Telfax : +91-0771-2575610,</p>	<p>Pune 2nd Floor, Kedar Empire, Near Paudphata Flyover, Opp. S.N.D.T. College, Karve Road, Pune - 411 038 (INDIA) Tel: +91 20 3028 3244, 3028 3245 Fax: +91 20 3028 3244</p>
<p>Chennai 53/96, IInd Floor, 4th Avenue, Ashok Nagar, Chennai - 600 083 (INDIA) Tel: +91 44 3918 0531-35 Fax: +91 44 3918 0536, 3918 0514</p>	<p>Hyderabad 126, Jayamansion, 3rd Floor, Sec -III, Opp. Paradise Kamat Hotel, S.D. Road, Hyderabad - 500 003 (INDIA) Tel: +91 40 3918 2485, 3918 2497 Fax: +91 40 3910 3631</p>	<p>Jaipur 2 floor , Roshan Tower , 12 Purohit Ji ka bagh Gopinath Marg, Jaipur -302001</p>